

TurningTalk

Turning Tomorrow's Treasures

Issue No 205

Newsletter of the South Auckland Woodturners Guild

October 2012

Woodturning New Zealand International Symposium Wesley College, Paerata, 4th to 7th October 2012

Well what can I say? The entire event was a huge buzz, and no matter whether you were one of the talented demonstrators, a member of the committee, a helper, or one of the many delegates from New Zealand or further afield, the beaming smiles told the story.

Being on the committee the build up was quite long, but when it came to the morning of Thursday the 4th of October it was all go. There were vendors setting up in the vendor hall. Club members unloading lathes and setting up all the equipment for the demo rooms. Many helpers setting up the silent auction, guess the wood, instant gallery, spoons competition in the foyer of the main hall. The registration desk busy as people arrived throughout the day. St John cadets helping where they could, packing goodie bags, sorting the coffee and tea and directing people to their sleeping quarters.

It was a great relief to sit down to dinner on the first night, in the knowledge that most of the set up was complete and there was little more we could do before everything was to kick off.

After dinner each of the demonstrators introduced themselves to the majority of the participants, I know that many started changing their plans of what they wanted to see during this. It also gave a real perspective to the breadth of talent that had been assembled.

Looking after the video equipment in the demo rooms gave me a great opportunity to interact with all the demonstrators. It became clear that although their individual talents were so varied they all loved what they were doing. They seemed to thrive with the level of interaction that was achieved by having a smaller scale event.

All the demonstrations I saw were excellent and I learnt a great deal from each one I attended, from the machine that was Glenn Lucas, to the delicate goblets made by Alan Carter, the contrast in styles was dramatic. Not only was it about the skills involved it also made me think that woodturners that through developing the craft were becoming artists, in contrast to artists that have moved into woodturning as one of their mediums, and there appeared to be a good balance from both perspectives in the selection of demonstrators.

The only downside of the whole event is having missed some of the demonstrations, and the choices became harder once you had been to a demo and wanted to see and hear more from these skilled craftspeople/artists.

Continued on Page 7 >>



Friday Night Audience for 'Blast from the Past'



Alan Carter



Neil Scobie



Guilio Marcolongo



Douglas Fisher



Niki Marshall



Alby Hall with Kelly Dunn

In this Issue

Symposium	1
Calendar	2
Shavings	3
Turning a Bean	4
Minatures	5
Aoraki Graduation	6
Symposium Cont.	7
www.sawg.org.nz	8

SAWG Committee

President

Bruce Wood 626 3840

Vice President

Darryl Pointon 294 7734

Past President

Bob Yandell 537 3815

Secretary

Robert Smith 536 4243

Treasurer

David Jones 299 5110

Editor

Ian Connolly 296 1312

Members

Lindsay Amies 537 1597

Mac Duane 299 6286

Cathy Langley 630 3091

Terry Scott 297 7051

Les Sivewright 534 7943

Dick Veitch 298 5775

Webmaster

Michele Pointon 294 7736

Club Meetings:

Wednesday Nights 7:00pm
(Doors open 5:00pm)

Club Rooms:

Papatoetoe Community Centre,
Tavern Lane, Papatoetoe,
Auckland, New Zealand

Website:

<http://www.sawg.org.nz>

Correspondence

Robert Smith
21 Omana Heights Drive
Maraetai
Auckland 2018
rasmith@ihug.co.nz

Newsletter contributions

editor@sawg.org.nz

Contributors this Month

Len Bacon
Mac Duane
Carole Knowles
Cathy Langley
Terry Scott
Dick Veitch
Photos - Ross Johnson/Ian Connolly



**South Auckland
Woodturners Guild**
is a member of the
**National Association of
Woodworkers NZ Inc.**
and the
**American Association of
Woodturners**



Our meetings are held Wednesday evening in our clubrooms in the Papatoetoe Stadium Community Centre, Tavern Lane, Papatoetoe (see www.sawg.org.nz for directions). The official meeting starts at 7:00pm.

For those wishing to make use of the machinery, do some shopping, check out the library, get some advice, or just socialise the doors open at 5:00pm.

Meetings include General Business, Show & Tell, Reports on Club Events and the demo or activity listed below.

Further information and the most up-to-date calendar can be found on our website at <http://www.sawg.org.nz>

Club Meeting Programme

24 Oct	Open Night at Carbatec
31 Oct	Metalled Ringed Mallet - Andrew Bright
7 Nov	Christmas Sale Discussion
14 Nov	Bee Keeping - Rodger Pye
21 Nov	Oval Turning - Ted McKinstry
28 Nov	Tunnelled Ball - Bruce Wood
5 Dec	Saturn Box (Ball Cutter) - Dick Veitch
12 Dec	Demo by Graeme MacKay - Life Members Award, Term Project

Upcoming Events

26-28 Oct	Waitaki Woodturners "Spin Around" Oamaru
2-4 Nov	Tauranga Woodcrafters Club - Annual Exhibition and Sale
December	SAWG Annual Christmas Sale
20 Feb 2013	Easter Show Entries Close - Schedule included in newsletter

Regularly Updated Calendars of Events can always be viewed at www.sawg.org.nz and www.naw.org.nz (including entry forms)

Macs Maxim

Make the best of today for you don't
know whats coming tomorrow.

- Mac Duane





Cover Photos on WoW

There have been a number of New Zealand Woodturners getting cover photos on the World of Woodturning site. Our club members are well represented, with these 3 seen in the last couple of months.



Carole Knowles - Omori Olive 2012



Gordon Pembridge - The Last of the Line



Terry Scott
"Cynthia made me do it"



The Woodturning Spirit.

A creative piece made by Terry Scott in collaboration with Terry Martin has been on the cover of the American Association of Woodturners website as turning of the week for the week starting 15 Oct 2012.

This piece also featured in the AAW magazine.

Symposium Feedback

We have had so much great feedback. Here is a sample of the sentiments that have been expressed. Without all the effort the whole club put in it could not have happened.

"You guys have just excelled, I have come home with so much that it's hard to really get it all sorted and I think every one else feels the same way, so you Dick and SAWG need to give yourselves a big round of applause mate, I think you just showed the rest of the world a thing or two.."

-- Colin Parkinson

"Thanks for a great weekend at the symposium the South Auckland Guild organized. The demonstrators were excellent along with a well organized team effort to make the weekend a great success. Congratulations."

-- B.N.Cowley

"Again a great show you've put on thank you"

-- Ian Outshoorn

"Thank you all so much for the wonderful woodturning conference. I thoroughly enjoyed myself and learnt heaps. I am so glad I attended and my only disappointment is that not more Australians took up the opportunity. Your attention to detail and organisational skills were superb. Your choice of venue was excellent. I hope that there will be another one in a couple of years, I will definitely be there."

-- Anne L Munro

Barry and Carole Knowles sent a symposium handbook to Mike and Cynthia Gibson after they took part from afar in the WoW swap at the Symposium - this is the feedback.

"WoW, I've never seen such an impressive handbook at any symposium, even our national! This was beautifully done. I am enjoying all of the information and photographs. I spoke with Molly a few days ago. She was overwhelmed with the experience!!"

--Mike and Cynthia Gibson

Club Night Action

Wednesday 19th September

I've Bean Thinking - Dick Veitch

Report by: Cathy Langley

When we heard that Dick was going to demonstrate seed pods, many of us assumed that we would see a variation on Neil Scobie's pods; or perhaps something like the "squirts", also inspired by Neil, that Graham Mackay demonstrated earlier this year. But no! Dick took his mission literally and went into the wild to consider the ways in which flora reproduce. Should he turn jacaranda seeds, or (very carefully!) agapanthus or kowhai seeds?

We were grateful that he settled on the humble broad bean, because that turned out to be more than sufficiently complex. Broad bean seed pods are curved, twisted, lumpy and split, and Dick incorporated all of these features into the final product, using only a spindle roughing gouge.



In the process he demonstrated the many effects that can be achieved by a careful adjustment of centres. He began by creating a cylinder and dividing it into five segments, then returned each segment with a different axis by using five different alignments between headstock and tailstock centres. The result was like a jointed, curved sausage. He then made that sausage oval by using two new centre combinations for each of the five segments, stopping the lathe frequently to check progress.

We began to see a bean pod, which Dick then made more realistic by using eight further centre combinations to turn four depressions into each side of the pod. The high spots in between the depressions indicated the presence of beans within the pod. Dick just happened to have a completed bean pod that had been carved at one end to show the edges of beans through a split in the pod – but that's optional!

This is not a project for those whose motto is "she'll be right." But if you enjoy precision, give this a go. The best way to "get" the principles of off-centre turning is to actually do it, so go to www.sawg.org.nz, then click on "projects", then "Projects A-D", then "Bean". Print out the project sheet, and check to make sure that it has printed at 100% by measuring the distances (either 5 or 10mm) between centres on the template. Cut out the circular templates, glue them on to the ends of your blank, and mark each centre. Follow the project sheet instructions very carefully, power sand your bean off the lathe to blend curves, and bring it in to show the rest of us!

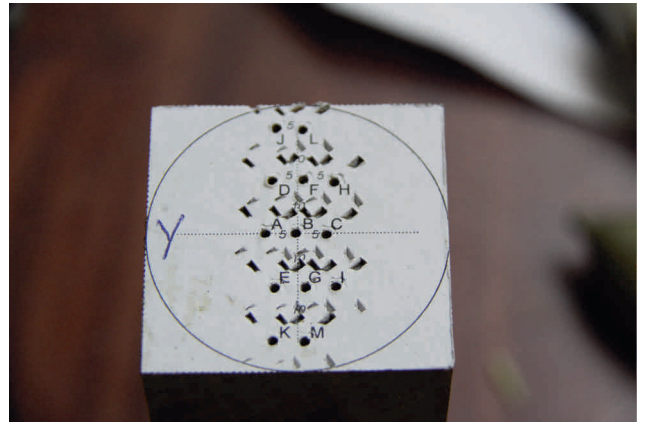

Club Night Action

Wednesday 26th September

Miniatures - Graham Bourquin (President West Auckland Woodturners)

Report by: Len Bacon

Graham started out by showing a display of some of his models that can only be described as "exquisite". They were in 'one inch to the foot' scale, including models of a spinning wheel, hand driven lathe, luggage trolley, barrels, buckets, and the like. A significant amount of effort is spent making jigs to suit each model so there needs to be the prospect of making a reasonable number of examples to make the time investment worthwhile.

Although commonly described as for the "dolls house market" these were anything but toys. (Graham quoted the example of a lady who flew her architect to France a couple of times to get the details right when designing her "Dolls House French Chateau")

The timber of choice is anything with a tight grain such as fruit wood, matai, privet, heart rimu, etc. and although he does use a Nova 3000 at times, he mostly uses a 30 year old, very solid, minilathe for the miniature work. This lathe runs at 2000RPM (but could easily go faster) and is modified with a dividing wheel; an impressive range of fine tool rests, and a frame to hold a sample above and behind the lathe bed when doing repetition work. To hold his work in the lathe he uses homemade face plates, and small drill chucks.

Most of his chisels are homemade from material like masonry nails and allen keys, his tool of choice being a small skew chisel. All his tools are sharpened on a flat plate of steel, or glass, with 800 grit wet and dry paper and a few drops of BBQ Flare Oil.

Plans for his projects come from a range of Dolls House publications, both local and international, and measurements are given to 1000th of an inch, for which Graham uses a digital vernier gauge, and small dividers.

Sanding is done with 6mm wide strips of Wet and Dry paper down to 1500 grit, backed with masking tape to stop it tearing too easily, and finished with sanding sealer for speed of drying.

Anyone contemplating similar projects needs to consider how good is their own close up vision and will probably need supplementary lenses of some sort to suit their own visual needs.

All in all it was a very entertaining evening by a very skilled craftsman, presented with wit and humour and a deep knowledge of his subject. Perhaps most surprising was the revelation that there is great international interest in dolls house miniatures and large amounts of money spent on the best examples.

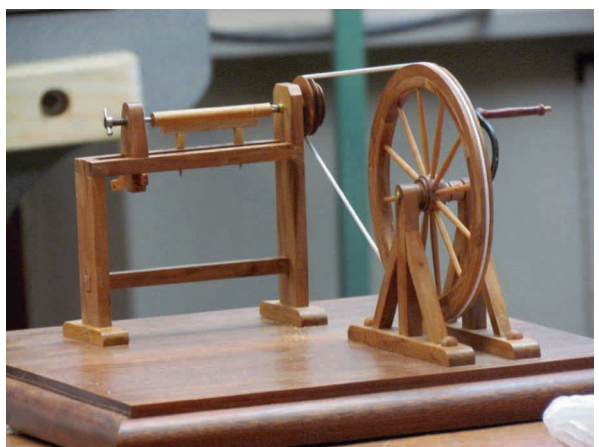

Club Night Action

Wednesday 3rd October

Special Meeting - Aoraki Graduation

Rather than the normal break for the school holidays we had a special meeting of the club on the 3rd of October. As it was the day immediately before the start of the Symposium we had a large number of guests in town including many of the demonstrators for the symposium.

First on the agenda we had Ann Fitzgerald from Aoraki Polytechnic to present the certificates to our first group of graduates from the course.

The graduates all got presented with their certificate and said a few words on what they got out of the course, I think I remember some of the things they said and the key points that they emphasized.

Bill Alden - has developed a love of making toys.

Lindsay Amies - loves the structured nature of the course.

Warwick Day - absent on the night, but I am sure he would have said something about planning your turning.

David Jones - pewter course very expensive.

Daryl Pointon - when he started he could only turn a bowl.

Michele Pointon - first experience of turning at all, needed to learn as Daryl was not producing the right things fast enough.

Graeme MacKay - helps in learning to plan work and forces a process.

Bruce Wood - got a lot out of the course and looks forward to putting more back in with tutoring future students.

Throughout special thanks went out to Cathy Langley and Dick Veitch for the huge amount of time and organisation that was going into the course. Cathy with all the administration (Lindsay is now helping out here as well) and Dick with all the collateral, and the huge number of teaching hours he has put in.

The tutors that contributed to the learning of these graduates with their dedication and time included, Dick Vietch, Cathy Langley, Tom Pearson, John Whitmore, Terry Meekan, Terry Scott, Gordon Pembridge and Mac Duane.

Next on the agenda we had Yvonne Brownlie, the General Manager of Look Good Feel Better to receive another batch of wig stands made by both the South Auckland and Franklin Woodturners.

Colin Wise received the table prize for the term. This prize is for the most times on the show and tell table during the term.

The Life Members Award for Excellence in Woodturning went to Peter Gray.

Terry introduced all the demonstrators that were there for the symposium and the night concluded with a pot-luck supper and a good chat.



A few samples of the work done during the Aoraki Course



Ann Fitzgerald presents Certificate to David Jones



Aoraki Graduates with Dick and Cathy



Yvonne Brownlie and Dick Veitch with a selection of the wigstands



Symposium Demonstrators introduced by Terry Scott

Symposium

>>continued from page 1

Other highlights included an instant gallery that contained a large number of pieces, and all to such a high standard. I am sure that Dick is expecting to see a greater number of entries for the Easter Show, now people have proved what they are capable of.

The evening entertainment organised by Terry Scott was excellent, 'Blast from the Past' on Friday night where Kelly Dunn, Glenn Lucas, Alby Hall and Neil Scobie shared their paths through life into woodturning was fascinating. Then Saturday night, well what can you say, two teams, Southern vs Northern Hemisphere, or Possum Pies vs French Fries, chefs hats, aprons, and other props, and a box of junk as one of the participants put it, a lathe and other tools (but no chainsaws). The simple instruction was to make breakfast. The teams really got into it and much fun was had by audience and participants.

A big thanks to all those that helped to make this happen, this includes those setting up, cleaning up, helping out wherever it was needed, sponsors, vendors, and of course the long suffering partners and families of those on the committee.

The feedback since the event has been tremendous, the WoW website is still buzzing 3 weeks later, and not just the delegates, also the demonstrators.



"Blast from the Past"



"Possum Pies"



Glenn Lucas



Molly Winton



"French Fries"



Mike Davies



Registration Desk - Michele, David,
Lindsay and Dick



Jasper Murphy



Gordon Pembridge



Molly Winton and Malcolm Zander



Liz Scobie

There have been a number of new project sheets appear on the website in the last couple of months, here is a sample of what has been appearing.

Dick is just quietly drawing up new sheets and passing them to Michele to load onto the website.

Somehow Dick has spare time, between visiting Woodturners around the country and chairing the organising committee for the symposium.

There are now more than 120 sheets including those of tips and jigs, make sure you take the time to have a look and make use of this awesome resource.

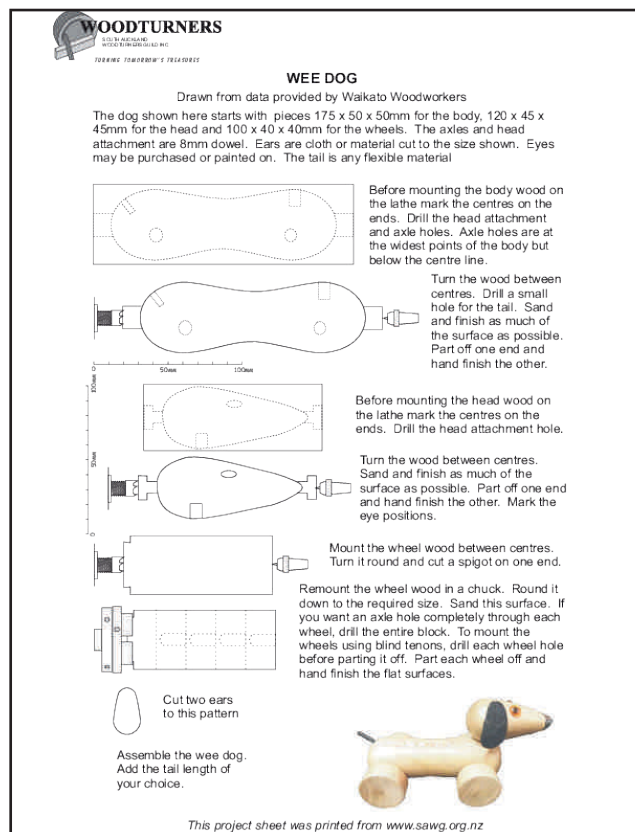
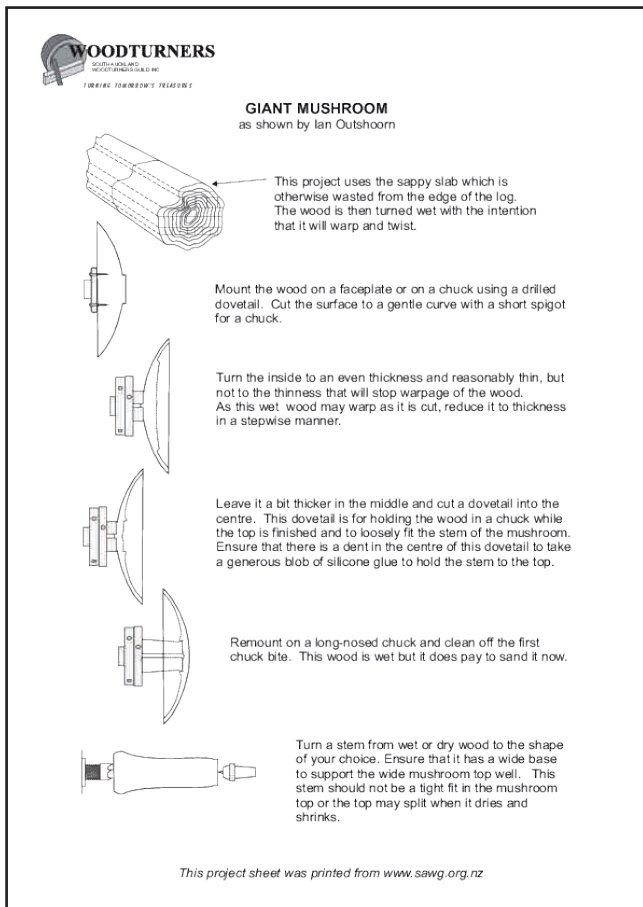
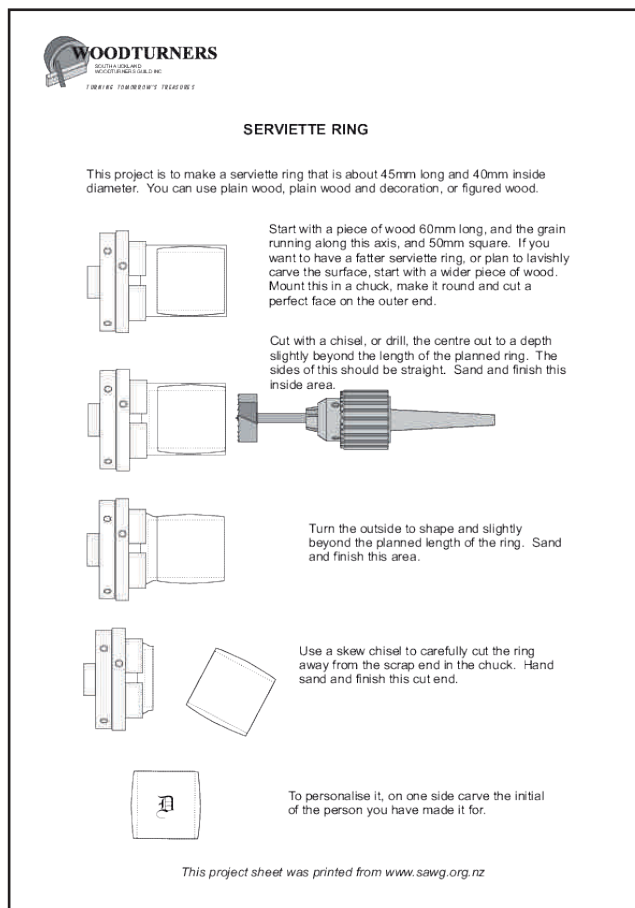

Sponsors' page

We value the support of our Sponsors. Please use their services whenever possible.

TIMBER

WOODTURNING BLANKS, SLABS & PLANKS

- GOOD SELECTION TO CHOOSE FROM -
- RECUTTING AND MACHINING SERVICE -

PHONE OR FAX 09 238 6197

JIM DOWNS

15 COULSTON RD, R.D.2, PUKEKOHE EAST

wattyl®

All products available from the Wattyl Trade Depots.

Manukau, 15 Jack Conway Ave. Phone: 263 6848

Takanini, 349 Great South Rd. Phone: 299 2137

Special rates for SAWG members



Suppliers of Abranet and Klingspor abrasives
sandpapers, discs and belts.

- Richard Lawton -

Ph: (09) 575 7681



GP SAWDOCTORS LTD

Alan Gater & Natalya Gater

21 Andromeda Crescent, East Tamaki, Auckland, New Zealand

T: 09 274 1700 F: 09 529 9081 E: sales@gpsaws.co.nz



BRIWAX®

The Professional's Choice

Hunter Tool Systems

Razor-sharp, long-lasting
edges for turners.

www.hunterwoodturningtool.com



POWERTOOL CENTRE

88 THE MALL
ONEHUNGA

PH: (09) 634 2511
FAX: (09) 634 1329

CEG-BROOK

ELECTRIC MOTORS

VARIABLE SPEED DRIVES

Motor Technologies Ltd Trading as: CEG-BROOK

Postal: PO Box 204 198, Highbrook, Auckland 2161

Physical: 63 Allens Road, East Tamaki, Auckland

Phone # 09 274 5353

CARBA-TEC®

TOOLS FOR WOOD

CARBA-TEC NEW ZEALAND LIMITED

Grant Oxenbridge

110 Harris Road, East Tamaki

PO Box 259 126, Greenmount, Auckland

Phone (09) 274 9454 Fax (09) 274 9455

Ph 0800 444 329 (orders only)

Email grant@carbatec.co.nz Website www.carbatec.co.nz

Available as Milled Timber, Slabs or Wood Turning Blocks
Rimu, Black Maire, Miro, Rewarewa, Ta-
wa, Kahikatea, Rata & Macrocarpa

Ross & Heather Vivian
VIVIAN INDIGENOUS TIMBER

P.O. Box 7, Stratford, Taranaki
Ph/Fax (06) 765 5219
Email: h.vivian@xtra.co.nz

Owners of one of the first areas of native bush registered
with a Sustainable Forest Management Plan in N.Z.

KTMP
*If you like the view,
So do we!*



Woodturning School of Excellence and makers of DVDs
www.ktmp.co.uk
Hunters Lodge, Church Lane, Strubby
Lincolnshire, LN13 0LR, UK

Quality WOOD CARVING TOOLS



Tungsten Carbide ~ burs ~ discs to fit grinders ~
sanding & polishing

FOR WOOD & BONE CARVERS,
PLASTICS, RUBBER, SOFT STONE



Shaft Sizes:
3/32"
1/8"
1/4"

AVAILABLE IN NZ FROM:
STEEL TOOLZ LTD
www.katools.co.nz
Phone 021 103-8844 steeltoolz@gmail.com



Carroll's
Woodcraft Supplies

Jim & Irene
03 5251 3874
cws01@tpg.com.au
www.cws.au.com
66 Murradoc Road Drysdale Victoria 3222

www.timberlywoodturning.co.nz

Rotary Tool Burrs



Wide variety available



TERRY SCOTT
NZ Agent for
BURNMASTER®
Also
Woodcut
TOOLS LIMITED
See website for more

Contact: timberly@xtra.co.nz for an info sheet or ph: (09) 297 7051

Remember, if I cannot break it, no-one can!



WOODTURNERS

SOUTH AUCKLAND
WOODTURNERS GUILD INC.

TURNING TOMORROW'S TREASURES

If undelivered, please return to:
PO Box 98836
Manukau City
Auckland 2241

Place
Stamp
Here